



12 Marline Court Little High Street | | Shoreham-By-Sea

BN14 5EQ



ESTATE AGENT



## 12 Marline Court Little High Street | | Shoreham-By-Sea | BN43 5EQ

£299,995

\*\*\* £299,995 \*\*\*

WARWICK BAKER ESTATE AGENTS ARE DELIGHTED TO OFFER TO THE MARKET THIS RARELY AVAILABLE ONE DOUBLE BEDROOM APARTMENT IN THE ROPETACKLE DEVELOPMENT, SHOREHAM TOWN CENTRE.

THIS STUNNING RAISED GROUND FLOOR APARTMENT HAS VIEWS OVER THE RIVER ADUR VIA PATIO DOORS AND BALCONY FROM THE LIVING DINING ROOM. THERE IS A 12'5 X 10'2 DOUBLE BEDROOM ALSO WITH VIEWS, FITTED MODERN KITCHEN, MODERN BATHROOM AND UNDERGROUND PARKING.

THE PROPERTY HAS NO CHAIN, IS VACANT. PLEASE CALL TO VIEW 01273 461144

- RIVER FRONT APARTMENT
- BALCONY WITH RIVER VIEWS
- PLEASE CALL TO VIEW
- ROPETACKLE DEVELOPMENT
- FITTED MODERN KITCHEN
- 01273 461144
- ONE DORUBLE BEDROOM 12'5 X 10'2
- TOWN CENTRE LOCATION
- LIVING DINING ROOM 28'1 X 11'
- UNDERGROUND PARKING

## COMMUNAL ENTRANCE

Gated entrance, communal door and entry phone system.

## ENTRANCE HALL

Doors giving access to Bathroom, Bedroom, Storage / Utility cupboard and

## LIVING / DINING ROOM

26'1" x 11' (7.95m x 3.35m)

Sliding patio doors leading out onto the balcony with stunning views of the River Arun, opening to

## KITCHEN

Range of fitted wall and base units, work surfaces, inset hob, oven under, extractor, inset sink unit, integrated appliances.

## BEDROOM

12'5" x 10'2" (3.78m x 3.10m)

Window with views over looking the River Arun, built in wardrobes.

## BATHROOM

Matching suite, panel enclosed bath

with shower attachment, pedestal wash hand basin, low level W.C.

## UNDERGROUND PARKING

Accessed via stairs or lift. Roller door.

## LEASEHOLD / OUTGOINGS

LEASE - 999 Years From 1 January 2004 - 979YRS REMAINING

MAINTENANCE - TBC

GROUND RENT - £200 PER ANNUM



# Marline Court, Little High Street, Shoreham-by-Sea, BN43

Approximate Area = 520 sq ft / 48.3 sq m  
For identification only - Not to scale

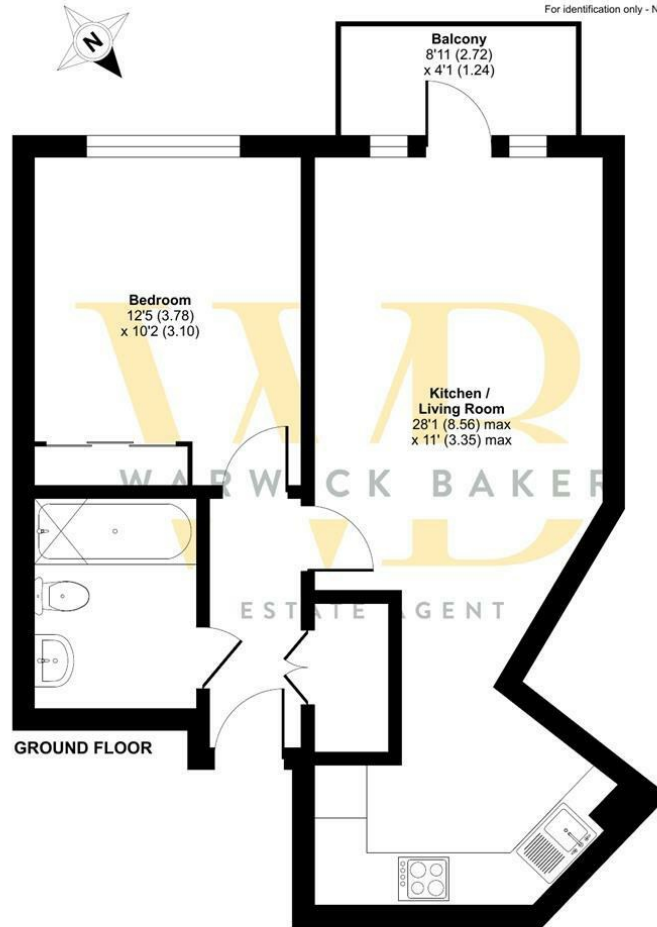

Floor plan produced in accordance with RICS Property Measurement Standards incorporating International Property Measurement Standards (IPMS2 Residential). © rickwcom 2024. Produced for Warwick Baker Estate Agent Ltd. REF: 1095310

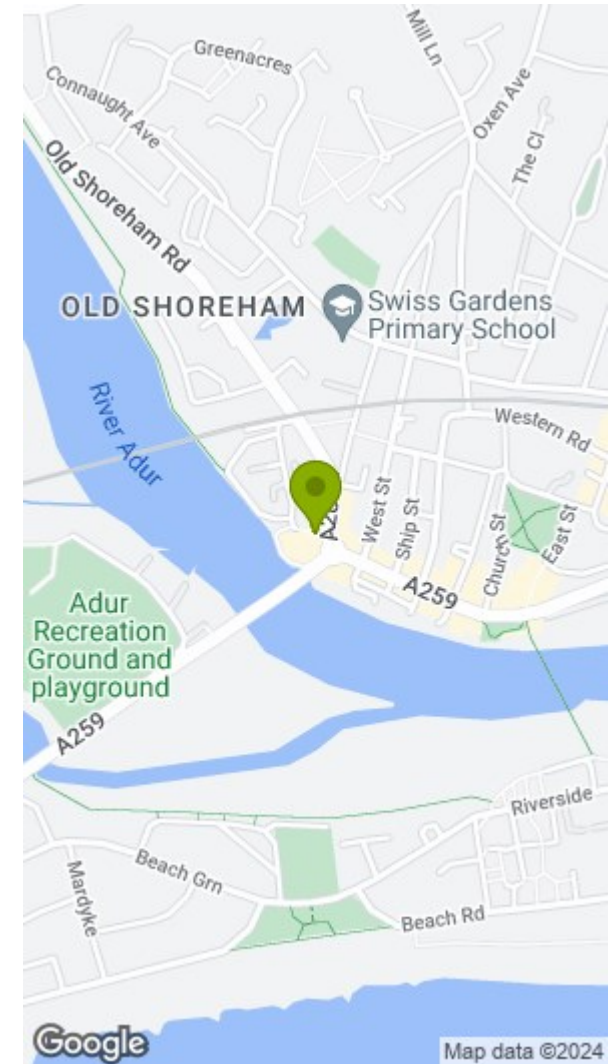

## Disclaimer

- \* These particulars are intended to give a fair and substantially correct overall description for the guidance of intending purchasers and do not constitute an offer or part of a contract. Prospective purchasers and/or lessees ought to seek their own independent professional advice.
- \* All descriptions, dimensions, areas, references to condition and necessary permissions for use and occupation and other details are given in good faith and are believed to be correct, but any intending purchasers should not rely on them as statements or representations of fact, but must satisfy themselves by inspection or otherwise as to the correctness of each of them.
- \* All measurements are approximate

Energy Efficiency Rating		Environmental Impact (CO <sub>2</sub> ) Rating	
	Current	Potential	
Very energy efficient - lower running costs			Very environmentally friendly - lower CO <sub>2</sub> emissions
(92 plus) <b>A</b>			(92 plus) <b>A</b>
(81-91) <b>B</b>			(81-91) <b>B</b>
(69-80) <b>C</b>			(69-80) <b>C</b>
(55-68) <b>D</b>			(55-68) <b>D</b>
(39-54) <b>E</b>			(39-54) <b>E</b>
(21-38) <b>F</b>			(21-38) <b>F</b>
(1-20) <b>G</b>			(1-20) <b>G</b>
Not energy efficient - higher running costs			Not environmentally friendly - higher CO <sub>2</sub> emissions
<b>England &amp; Wales</b>	EU Directive 2002/91/EC		<b>England &amp; Wales</b>
			EU Directive 2002/91/EC